

FORM NO 1.

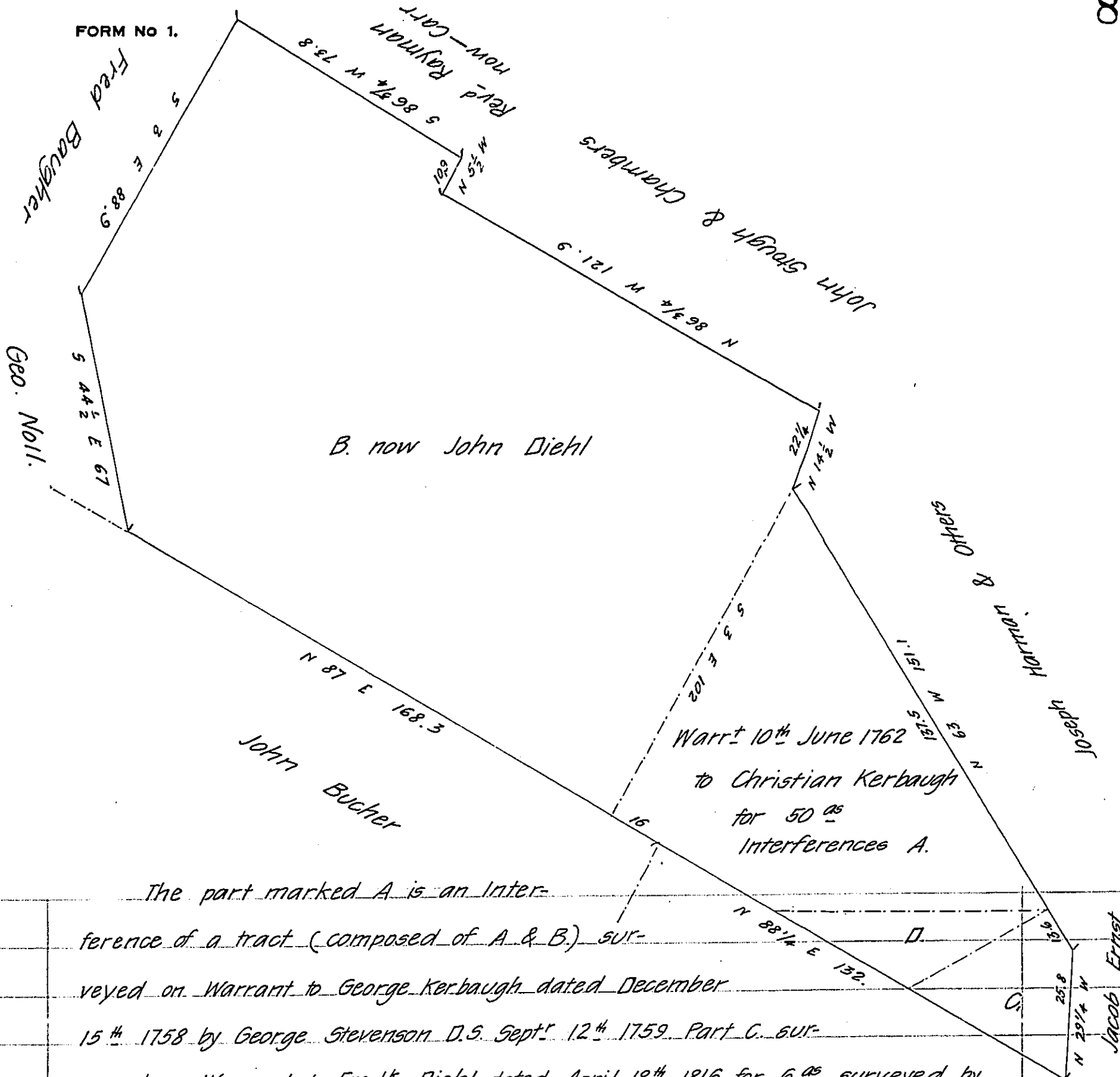

The part marked A is an Interference of a tract (composed of A & B) surveyed on Warrant to George Kerbaugh dated December 15<sup>th</sup> 1758 by George Stevenson D.S. Sept<sup>r</sup> 12<sup>th</sup> 1759. Part C. surveyed on Warrant to Fred<sup>k</sup> Diehl dated April 18<sup>th</sup> 1816 for 6<sup>ac</sup> surveyed by Sam<sup>l</sup> Sloan Nov 5<sup>th</sup> 1818 - Part D surveyed on Warrant to John Diehl for 5<sup>ac</sup> surveyed by Sam<sup>l</sup> Sloan Decb<sup>r</sup> 14<sup>th</sup> 1820 - The whole Containing 200<sup>ac</sup> & 34 p<sup>s</sup> & all<sup>ac</sup> now owned by John Diehl, situate in Berwick Township Adams County and all Unpatented at this date. Witness my hand Sept<sup>r</sup> 21<sup>st</sup> 1837 Jn<sup>o</sup> L. Gubernator. -

IN TESTIMONY that the above is a copy of the original remaining on file in the Department of Internal Affairs of Pennsylvania, made conformably to an Act of Assembly approved the 16th day of February, 1833, I have hereunto set my Hand and caused the Seal of said Department to be affixed at Harrisburg, this twelfth day of October 1908

*Henry Howard*  
Secretary of Internal Affairs.